



PLEASE READ THIS INSTRUCTION MANUAL
CAREFULLY BEFORE USING THE PRODUCT.
PLEASE KEEP THIS MANUAL PROPERLY FOR
FUTURE REFERENCE.

KALCES ORQUE V2

B O D Y B O A R D

INSTRUCTION MANUAL

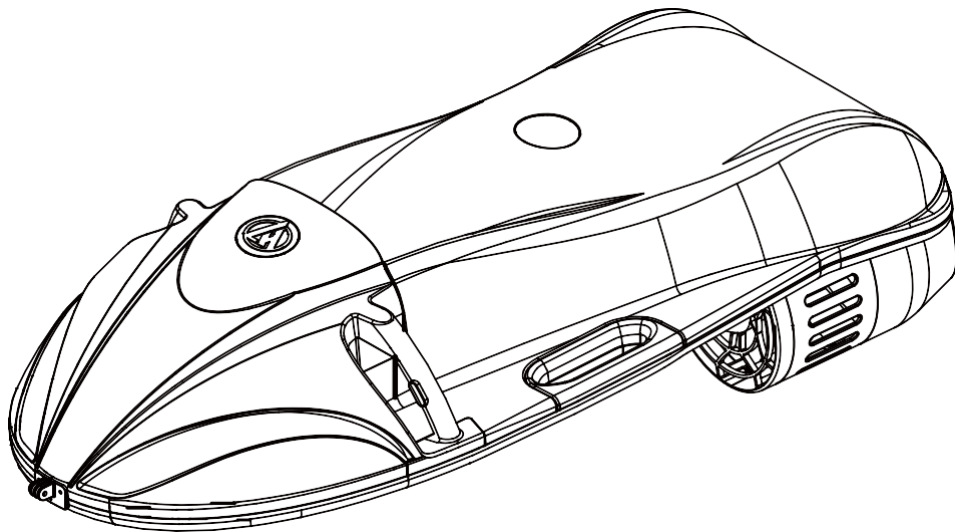

01/PACKING LIST

NO	NAME	QUANTITY
1	ORQUE Jetboard	1
2	ORQUE Waterproof Batteries	1
3	Charging adapter	1
4	User Manual	1
5	Plug-in Kit	1

PRODUCT DESCRIPTION

- 1 The ORQUE bodyboard adopts an injection molding process, a utility model patented water proof battery compartment, which is convenient for disassembly and installation. The user can remove and replace the battery easily, and the waterproof rating is IP68.
- 2 The ORQUE bodyboard adopts the patented design of ship type, which can weaken the resistance of water. it has strong buoyancy, so it also can be used as a rescue board in an emergency.
- 3 The ORQUE bodyboard uses an intelligent integrated control system, three speed modes (low/middle/high), and each gear is integrated into a fixed—speed cruise mode.
- 4 The ORQUE bodyboard's Stop&Start system. It will automatically standby after 5 minutes of use and automatically shut down after 10 minutes of use.
- 5 ORQUE bodyboard has a gopro camera bracket interface.

02/Product Information

Name	Specification
Product model	ORQUE bodyboard
Product color	flame orange / Proton red / (Color can be customized)
Package dimensions	1 0 9 C M * 5 7 C M * 4 1 C M
Product gross weight	2 5 . 5 KG
Product Net Weight	1 6 . 9 KG
Capacity	<150 KG
Speed	10—18 KM / H (over water) ; 6—12 KM / H (under water)
Product material	ABS + PC
Size	1 0 0 C M * 5 0 C M * 3 4 C M
Propeller blades	Three/ 7.25inch
Number of tNrusters	Two
Propeller power	2 000 W * 2
Speed Mode	Low/ middle/high + cruise control
Propeller installation method	Independent suspension
Battery installation method	Quick plug—in self—locking
Battery configuration	Standard 15AH
Charging adapter	DC54.6V / 5A
Charging method	Contact-type
Charging time	2.5 hours
Endurance mileage	30 - 120 minutes
Waterproof rating	IP68

03/Product Introduction

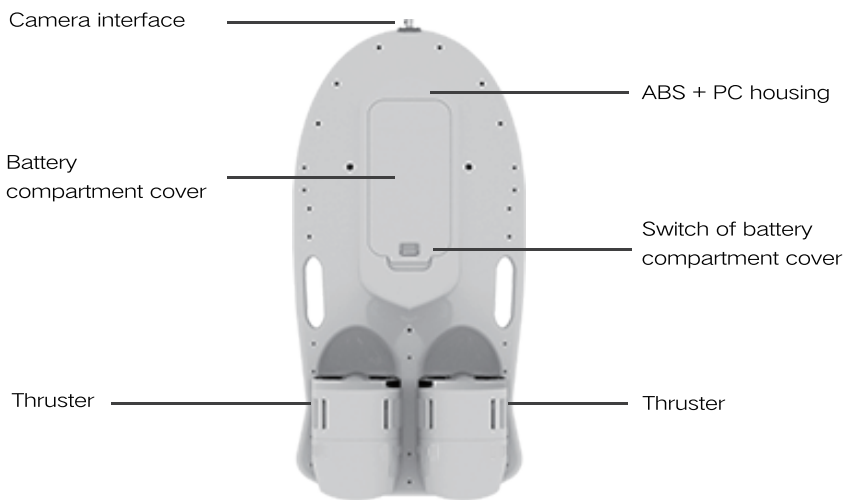
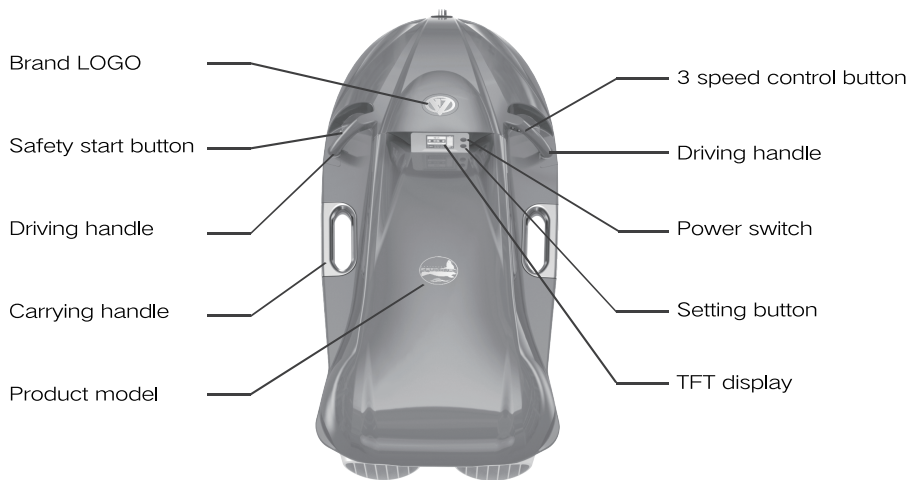

04/Product manual

1、Battery installation instructions

First take out the female end of the battery compartment power cord plug, and insert the male terminal of the battery according to the plug logo. The sound of "click" prompts the interface to be locked. You can gently pull the plug to confirm; then put the battery power cord into the battery compartment wire slot and battery plug Align the end with the plug slot and the buckle at the mouth. Put the battery into the battery compartment at the lower end, and then press the other end of the battery to gently press down. The buckle of the battery compartment "click" prompts to lock, you can gently lift the battery strap to confirm; then buckle For the battery compartment cover, toggle the elastic switch of the compartment cover to open and close and lock. As shown in picture ①②③

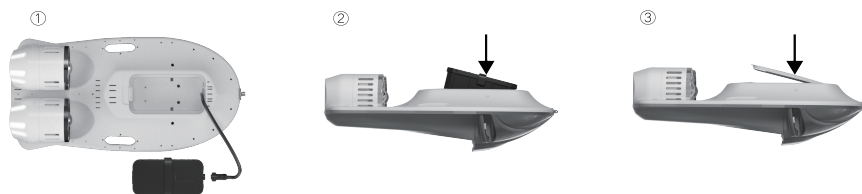

2、Instructions for use of power plug

① Install the power plug:

Insert the female end of the power cord plug into the male connector of the battery according to the plug logo. A click will prompt the interface to be locked. You can gently pull the plug to confirm;

②Remove the power plug:

Press the two small ears on the female end of the power cord plug by hand, refer to the arrow of the plug logo, rotate counterclockwise to the limit, and pull it out;

3、Charging matters instruction

① When charging, connect the power plug, refer to the above 2①.

②The red light on the charger indicates that battery is charging, green light indicates charging completed, and please stop charging when light is green. Long-time charging could cause sever damage to battery.Make sure charge the battery once a month when not using it often, otherwise battery could be damaged as well.

③ After the charging completed, unplug the charger from the electric outlet, then disconnect the battery from the charger, refers to ② above. When the product is not used often, please put it in a dry and ventilated place.

4、Reminder

① When charging, please make sure that the charging port is dry. Don't get the plug and charger wet, because this may cause electric shock. Do not touch it with wet hands. During the charging process, if there is any malfunction, immediately unplug the charger.

② Please pull out the plug, do not pull the plug from the charging cable. If the charger or charging cable is obviously damaged, please replace it in time.

③When charging, the product must be placed in a safe area,Keep your children away from it.

05/Instructions

- 1 Hold the power switch for 3 set seconds to turn the display screen on. It always memorizes last speed set. To switch the speed modes, press "+" and "-" on the right handle. To start the machine or get into standby mode, Press "safety key" on the left handle. Hold the power switch for 3 seconds to shut down.
- 2 Press and hold the power switch for 3 seconds to shut down the system; the product stops using for 5 minutes, the system enters an automatic standby state, and shuts down automatically after 10minutes.
- 3 When use the product, first turn on the Power switch, the driver stands in the water, then gently lay on the ORQUE. hold both handles when you are driving, choose a speed gear that you are happy with and can adjust the speed gear according to his needs.
- 4 You can also turn off the ORQUE and use it as a swimming board.
- 5 Slightly tilt your body to turn right or left.
- 6 ① Settings (language setting):
 - 1) Long press the "Settings" button for 3 seconds to enter the setting interface;
 - 2) After entering the interface, use the "+" and "-" button on the right control handle to select the option (language) to be set, and after selecting it, short press the setting button Confirm the setting item (language);
 - 3) After entering the setting item, select the setting content (English or Chinese) with the "+" and "-" keys on the right control handle, and short press the "Settings" key to confirm;
 - 4) After the setting is completed, long press the "Settings" button for 3 seconds to exit the setting interface;

② Setting (warning battery): the method is the same as above;

③ Setting (gear setting): the method is the same as above;

Description of gear mode:
Manual mode: the factory default mode, in this mode, the gear can be switched at will by the "+" and "-" keys on the right control handle;
High, medium and low gear modes: The gear positions set through the setting interface are fixed, and the gear positions cannot be switched by the "+" and "-" button on the right control handle.



prompt

- 1 ORQUE seal airship is not a substitution for life-saving supplies, Using in a intensive situation is not recommended
- 2 Make sure that the power plug is locked tightly to avoid water short circuit at the power interface. Please power on and debug the product before launching it as soon as possible after use.